

# Atlantis Vertical Garden Systems

Gro-Wall<sup>®</sup> Version 4.5

Gro-Wall<sup>®</sup> Slim Pro **NEW**

Gro-Wall<sup>®</sup> Slim Line **NEW**

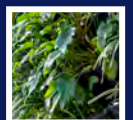

# Vertical Gardens

## Vertical Gardens Made Easy!

Atlantis vertical garden systems facilitates installation of vertical gardens in adverse outdoor environmental conditions and in regulated indoor environments with complete access and control.

Our vertical gardens systems provide targeted watering control of individual plants, maximum water efficiency, last minute design changes and easy access to irrigation components.

## Benefits

- Rapid Construction
- Quick Plant Installation
- Vertical & Horizontal Expansion
- Easy Creative Planting Design
- Self Supporting Structure
- No Framework Required
- Structurally Strong
- Modular Planting System
- Optimum Moisture Retention for Plants
- Easy Individual Plant Access & Maintenance
- Excess Water Capture System Available



Gro-Wall® 4 installed onto office, Croatia 2016.

## Why Use Gro-Wall®



**Water Efficient**  
Gro-Wall® is highly water efficient. The system can be tailored to water plants without excess runoff.



**Modular System**  
Gro-Wall® is a modular system allowing easy vertical and horizontal expansion.



**IPI™ System**  
Gro-Wall® features individual plant Irrigation system.



**Thermal Insulator**  
Gro-Wall® performs as a thermal insulator for buildings, cooling in summer and retaining heat in winter.



**Recycled Materials**  
Gro-Wall® is made from high quality recycled materials.



**IFS™ System**  
Integrated frame work system. Gro-Wall® is fixed directly onto the wall. No additional framework is required.



**Sound Insulation**  
The Gro-Wall® 4 design is a highly effective sound insulator holding up to 140L of soil media per square metre.



**Versatile Planting**  
Gro-Wall® 4 can accommodate a large variety of plant species including grasses, Sedums, Succulents.



**Complete Access**  
Gro-Wall® allows complete & easy access to individual plants and irrigation components.



# Gro-Wall® Slim Pro

## PROFFESIONAL SLIM VERTICAL GARDEN SYSTEM

The Gro-Wall® Slim Pro is a new vertical garden green wall system with a thinner profile making the system ideal for applications where space is limited.

The new features include built in drainage within the framework, planter tray locks automatically when inserted and the irrigation can now be mounted on the front of the unit as well as in the center of the unit. The new planter tray is thinner and allows for 6 litres of soil media ensuring healthy plant growth and moisture retention.

Plant to plant irrigation is beautifully balanced providing evenly distributed irrigation to the plant below. It is also now optional, and can be blocked off to allow the water to drain away to a drainage outlet with the use of irrigation pipes. This feature is ideal for indoor applications where drainage outlets are not available or for applications that require plants to be self contained so as to prevent plant disease spreading to other plants.

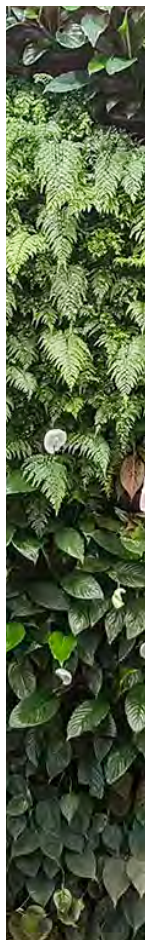
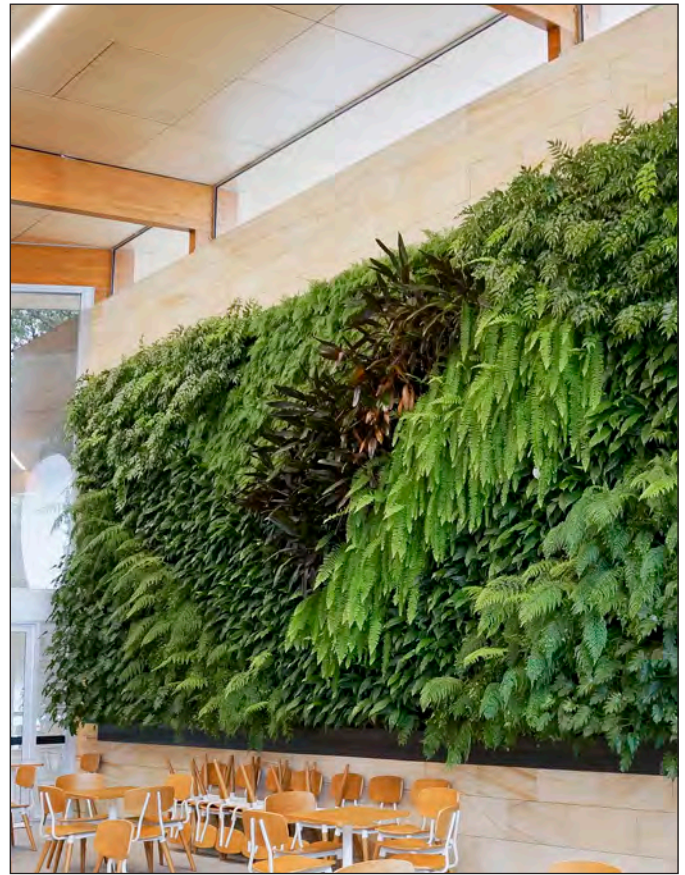

## Gro-Wall® Slim Pro at a Glance

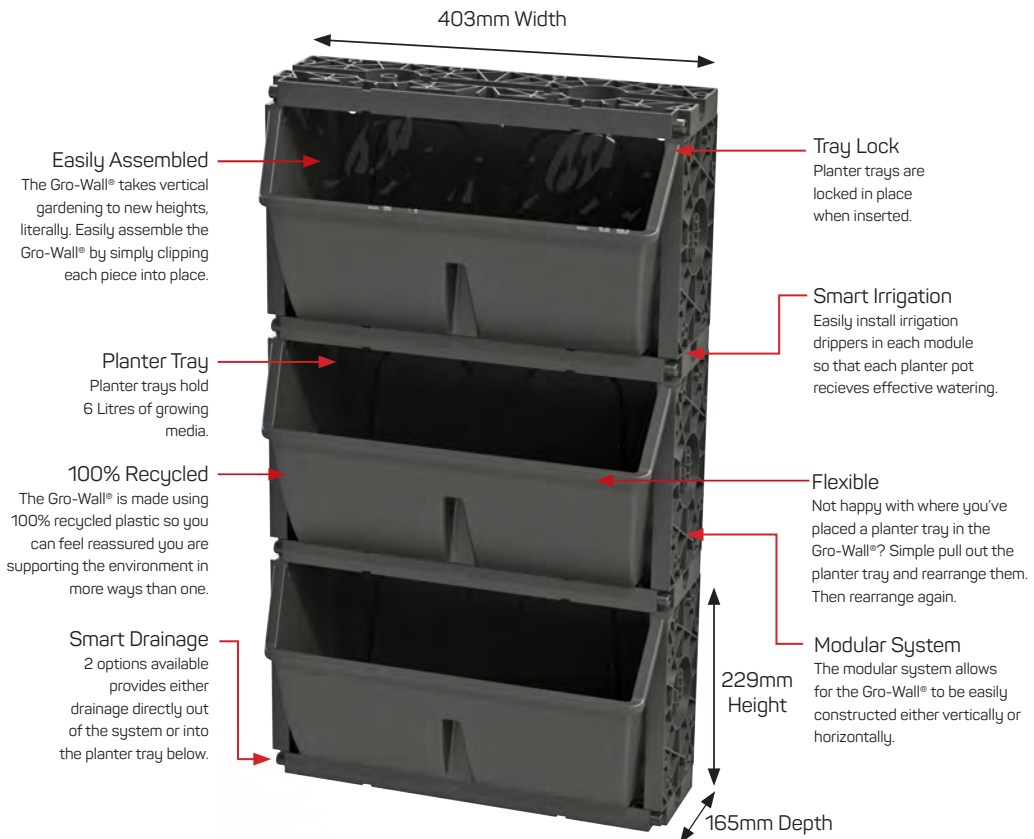

# Gro-Wall® Slim Line

## SLIM LINE VERTICAL GARDEN SYSTEM

The Gro-Wall® Slim Line is a new vertical garden green wall system that provides a thinner profile making the system ideal for applications where space is limited.

The new features include built in drainage sockets and irrigation locking clips. The new planter tray is thinner in depth and allows for 6 litres of soil media ensuring healthy plant growth and moisture retention.

Plant to plant irrigation is beautifully balanced providing evenly distributed irrigation to the plant below. The Planter tray features drainage sockets that can be connected to standard irrigation pipes for connection to a drainage locations on site. This feature is ideal for indoor applications where drainage outlets are not available near the green wall vertical garden installation.



### Gro-Wall® Slim Line at a Glance

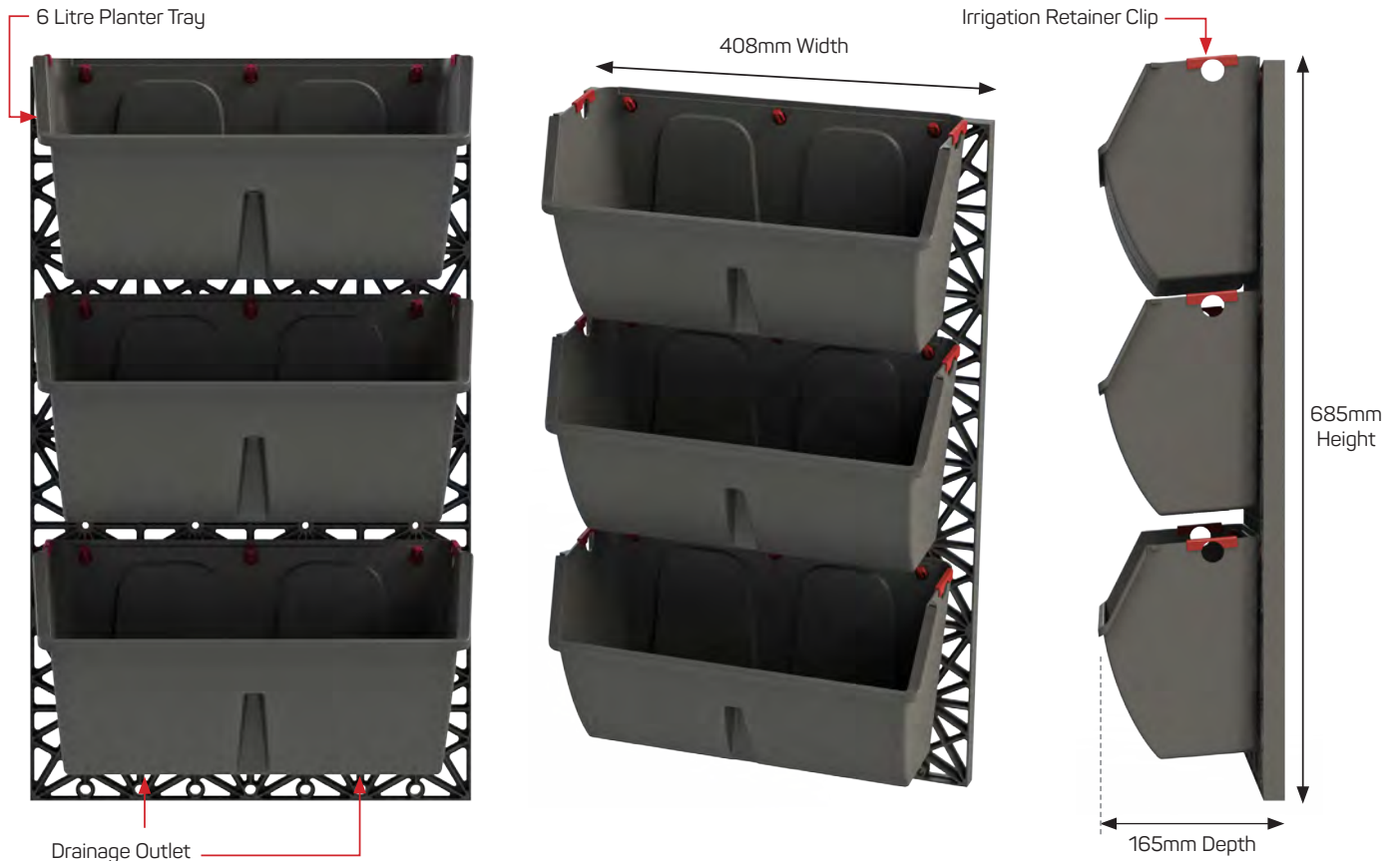

# Gro-Wall® 4.5

**NEW** Gro-Wall® 4.5 Features Pot Locking.

Gro-Wall® 4.5 is the latest version of the well loved vertical garden system. This modular green wall product is an excellent solution where the priority is instantaneous beautiful aesthetics and minimal maintenance.

The system incorporates an integrated rigid framework that incorporates the conduits for individual plant irrigation.

The large pots accommodate 6.5 litres of soil media perfect for flourishing plant growth. The pot feature built in water reservoir and drainage for the excess water.

## Easy Access

Gro-Wall® permits easy and complete access to both plants and irrigation components. This feature enables easy design changes and maintenance. Removal of individual plants and access to the irrigation components can be achieved in seconds.



## Versatile Irrigation

Gro-Wall® 4.5 features IPI™ individual plant irrigation provision that allows conventional drip emitter and irrigation conduits to be installed within the Gro-Wall® framework. Each plant cell is irrigated directly via a drip emitter which is installed into the system.

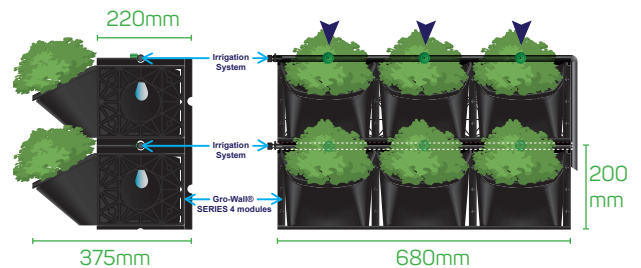

**Pots are easily installed and removed in seconds.**

**Smart Irrigation**  
Easily install irrigation drippers in each module so that each planter pot receives effective watering. This means you don't have to soak the top row so that the bottom row receives water.

**Easily Assembled**  
The Gro-Wall® takes vertical gardening to new heights, literally. Easily assemble the Gro-Wall® by simply clipping each piece into place.

**100% Recycled**  
The Gro-Wall® is made using 100% recycled plastic so you can feel reassured you are supporting the environment in more ways than one.

### Gro-Wall® 4.5 at a Glance

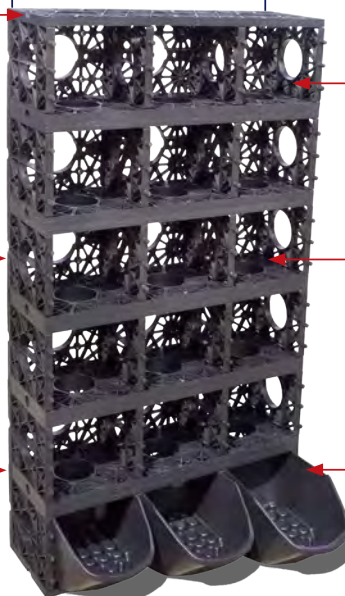

**Modular System**  
The modular system allows for the Gro-Wall® to be easily constructed either vertically or horizontally.

**Flexible**  
Not happy with where you've placed a plant in the Gro-Wall®? Simple pull out the planter pot and rearrange them. Then rearrange again.

**Planter Pots**  
Each planter pot has the capacity to contain 6.5L of soil, more than enough for healthy plants. Pots can be locked in place using a locking pin.

## Gro-Wall® 4.5 Module Size

A single Gro-Wall® module measures 680mm in width, 200mm in height and 220mm in depth. When the pot is inserted the depth increases to 375mm. A kit of Gro-Wall® includes 6 modules which measures 1200mm in height if the modules are stacked on top of each other.

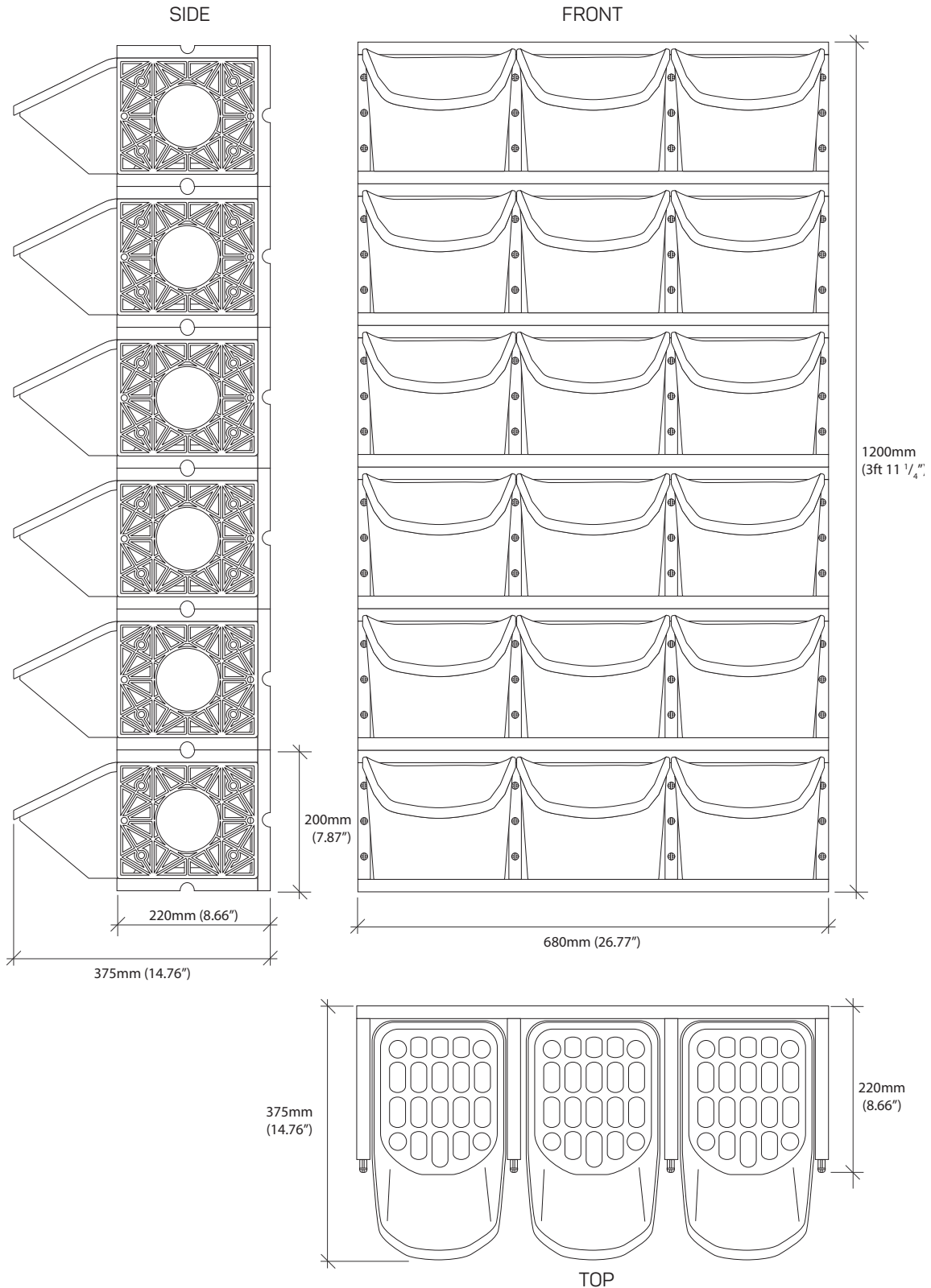

# Gro-Wall®

VERTICAL GARDEN SYSTEM



**Atlantis®**  
GREEN CITIES FOR LIFE

ATLANTIS CORPORATION AUSTRALIA PTY LTD

Phone: (02) 9417 8344

Fax: (02) 9417 8311

Email: [info@atlantiscorp.com.au](mailto:info@atlantiscorp.com.au)

Web: [www.atlantiscorp.com.au](http://www.atlantiscorp.com.au)

**Note:** Atlantis products are manufactured from carefully selected high quality recycled materials. The strength of the recycled plastic could vary slightly due to raw material composition, country of manufacture, manufacturing process and external conditions. All trademarks are the property of Astral Property Pty Ltd.

**Disclaimer:** All information provided in this publication is correct to the best knowledge of the company and is given out in good faith. This information is intended only as a general guide, no responsibility can be accepted for any errors, omissions or incorrect assumption. As each project is unique, and as Atlantis Corporation Australia Pty Ltd and its distributors and agents world wide have no direct control over the methods employed by the user in specifying, installing or supervising of its products hence no responsibility is accepted by Atlantis Corporation Australia Pty Ltd and its distributors and agents world wide. Users should satisfy themselves as to the suitability of the product for their purpose. All product designs, and specification are subject to change without further notice. All Atlantis products are tested in approved laboratories, and safe allowed tolerances should be practised in the actual field, to compensate for any unforeseen situations, on site and on products. All material contained within this brochure is subject to copyright, and belongs to Atlantis Corporation Australia Pty Ltd. No part of this brochure may be reproduced or transmitted in any form or by any means, electronic, mechanical, photocopying, recording or otherwise, without prior written permission of Atlantis Corporation Australia Pty Ltd. Copyright @ 2016